

CCUFSA 2010 (Canadian College University Food Service Association)

July 2, 2010
Place Bonaventure
Niveau 200 nord

ENTRANCE

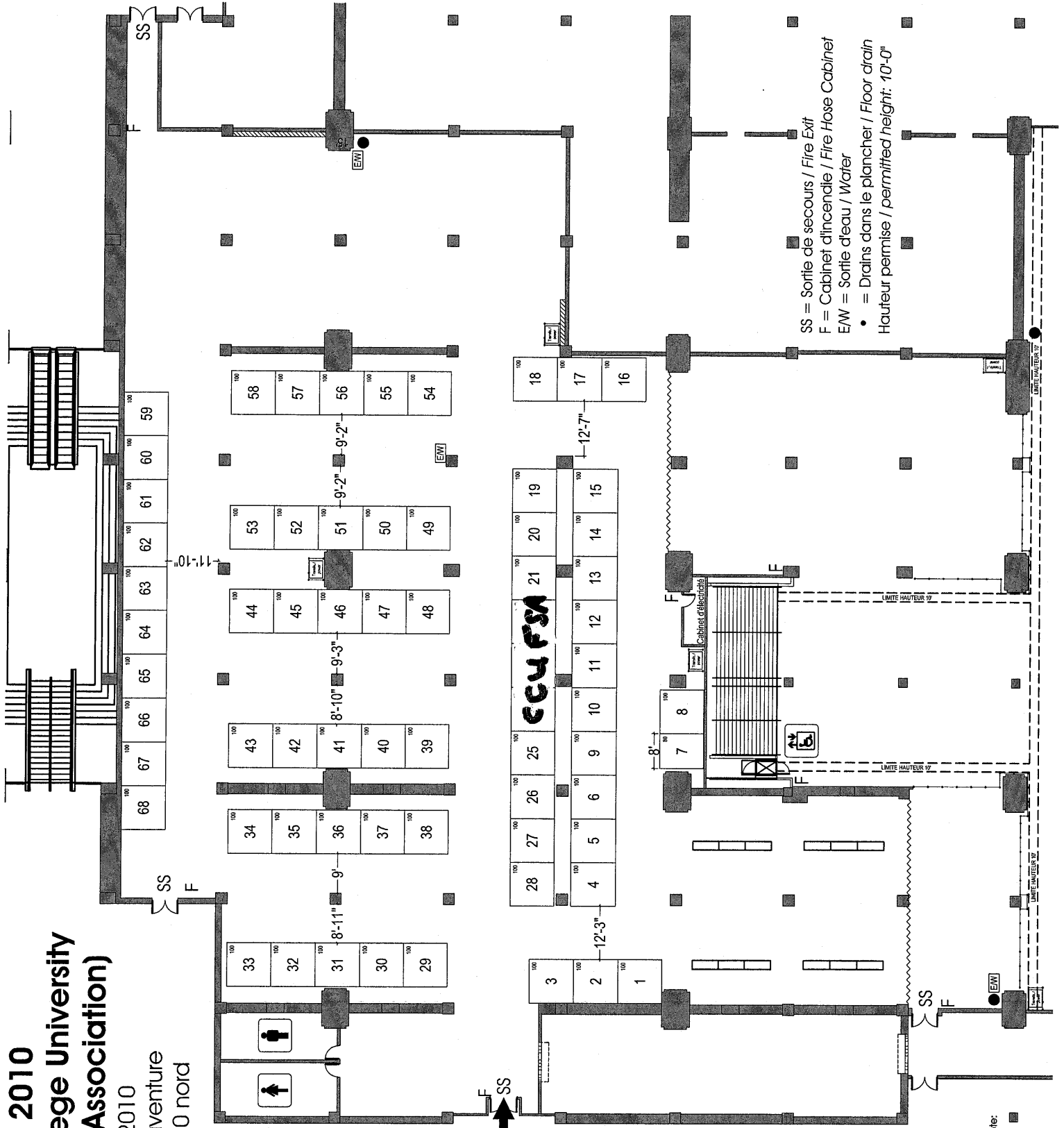

SS = Sortie de secours / Fire Exit
F = Cabinet d'incendie / Fire Hose Cabinet
E/W = Sortie d'eau / Water
• = Drains permise / Floor drain
Hauteur permise / permitted height: 10'-0"

